

Motoriduttori brushless CC epicicloidali

Brushless DC planetary gearmotors

P52 con motore brushless

P52 with brushless motor

P52			BLS022.240														
			24V						36V								
Ns	ir	in	n _{2MIN} [rpm]			n _{2MAX} [rpm]			n _{1MAX} [rpm]	n _{2MIN} [rpm]			n _{2MAX} [rpm]			n _{1MAX} [rpm]	
			M ₂ [Nm]	sf		M ₂ [Nm]	sf			M ₂ [Nm]	sf		M ₂ [Nm]	sf			
1	3.7	4	81	0.7	9.0	811	0.7	6.1	3000	108	0.7	9.0	1081	0.7	5.4	4000	
	4.28	4	70	0.8	7.8	701	0.8	5.3		93	0.8	7.8	935	0.8	4.7		
	5.18	5	58	0.9	6.4	579	0.9	4.4		77	0.9	6.4	772	0.9	3.9		
	6.75	7	44	1.2	4.9	444	1.2	3.3		59	1.2	4.9	593	1.2	3.0		
2	13.73	14	22	2.3	7.6	218	2.3	5.2		29	2.3	7.6	291	2.3	4.6		
	15.88	16	19	2.6	6.6	189	2.6	4.5		25	2.6	6.6	252	2.6	4.0		
	18.36	18	16	3.0	5.7	163	3.0	3.9		22	3.0	5.7	218	3.0	3.4		
	19.2	19	16	3.2	5.4	156	3.2	3.7		21	3.2	5.4	208	3.2	3.3		
	22.2	22	14	3.7	4.7	135	3.7	3.2		18	3.7	4.7	180	3.7	2.8		
	25.01	25	12	4.1	4.2	120	4.1	2.8		16	4.1	4.2	160	4.1	2.5		
	26.9	27	11	4.4	3.9	112	4.4	2.6		15	4.4	3.9	149	4.4	2.3		
	28.9	29	10	4.8	3.6	104	4.8	2.5		14	4.8	3.6	138	4.8	2.2		
	35.0	35	8.6	5.8	3.0	86	5.8	2.0		11	5.8	3.0	114	5.8	1.8		
	45.6	46	6.6	7.5	2.3	66	7.5	1.6		8.8	7.5	2.3	88	7.5	1.4		
	3	50.9	51	5.9	8	4.7	59	7.8		3.2	7.9	8	4.7	79	7.8		2.8
		58.9	59	5.1	9	4.1	51	9.1		2.8	6.8	9	4.1	68	9.1		2.4
68.1		68	4.4	10	3.5	44	10	2.4	5.9	10	3.5	59	10	2.1			
71.2		71	4.2	11	3.4	42	11	2.3	5.6	11	3.4	56	11	2.0			
78.7		79	3.8	12	3.0	38	12	2.1	5.1	12	3.0	51	12	1.8			
92.7		93	3.2	14	2.6	32	14	1.7	4.3	14	2.6	43	14	1.5			
95.2		95	3.2	15	2.5	32	15	1.7	4.2	15	2.5	42	15	1.5			
99.5		100	3.0	15	2.4	30	15	1.6	4.0	15	2.4	40	15	1.4			
107.2		107	2.8	17	2.2	28	17	1.5	3.7	17	2.2	37	17	1.3			
115.07		115	2.6	18	2.1	26	18	1.4	3.5	18	2.1	35	18	1.2			
123.97		124	2.4	19	1.9	24	19	1.3	3.2	19	1.9	32	19	1.2			
129.62		130	2.3	20	1.8	23	20	1.3	3.1	20	1.8	31	20	1.1			
139.13		139	2.2	21	1.7	22	21	1.2	2.9	21	1.7	29	21	1.0			
149.9		150	2.0	23	1.6	20	23	1.1	2.7	23	1.6	27	23	1.0			
168.84		169	1.8	26	1.4	18	26	1.0	2.4	26	1.4	24	26	0.8			
181.24		181	1.7	28	1.3	17	28	0.9	2.2	28	1.3	22	28	0.8			
195.26	195	1.5	30	1.2	15	30	0.8	2.0	30	1.2	20	30	0.7				
236.09	236	1.3	36	1.0	13	36	0.7	1.7	36	1.0	17	31	0.7				
307.54	308	1.0	47	0.8	9.8	36	0.7	1.3	47	0.8	13	31	0.7				

Rapporti preferenziali
Preferred ratios

Attenzione: superamento della coppia nominale supportata dal riduttore per servizio S1.
Contattare il ns. servizio tecnico
Attention: rated torque withstood by gear reducer for service in S1 is exceeded.
Please, contact our technical office.

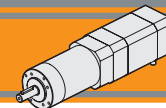

P52 con motore brushless CC

P52 with brushless DC motor

Tipo Type	Numero di poli Number of poles	Numero di fasi Number of phase	Tensione Rated voltage [V]	Numero di giri Rated speed [rpm]	Coppia nominale Rated torque [Nm]	Potenza nominale Rated power [W]
BLS022.240	4	3	36	4000	0.22	92
			24	3000		70
Tipo Type	Coppia massima Peak torque [Nm]	Corrente nominale Rated current [A]	Resistenza Resistance [ohm]	Induttanza Inductance [mH]	Corrente massima Peak current [A]	Peso Weight [kg]
BLS022.240	0.44	3.7	0.64	3.1	7.4	0.72

Azionamenti
Drives



P52.. + BLS022.240

Linguetta 4x4x16
DIN 6885
Key 4x4x16
DIN 6885

Kg
2.3 (P52 1..)
2.5 (P52 2..)
2.7 (P52 3..)

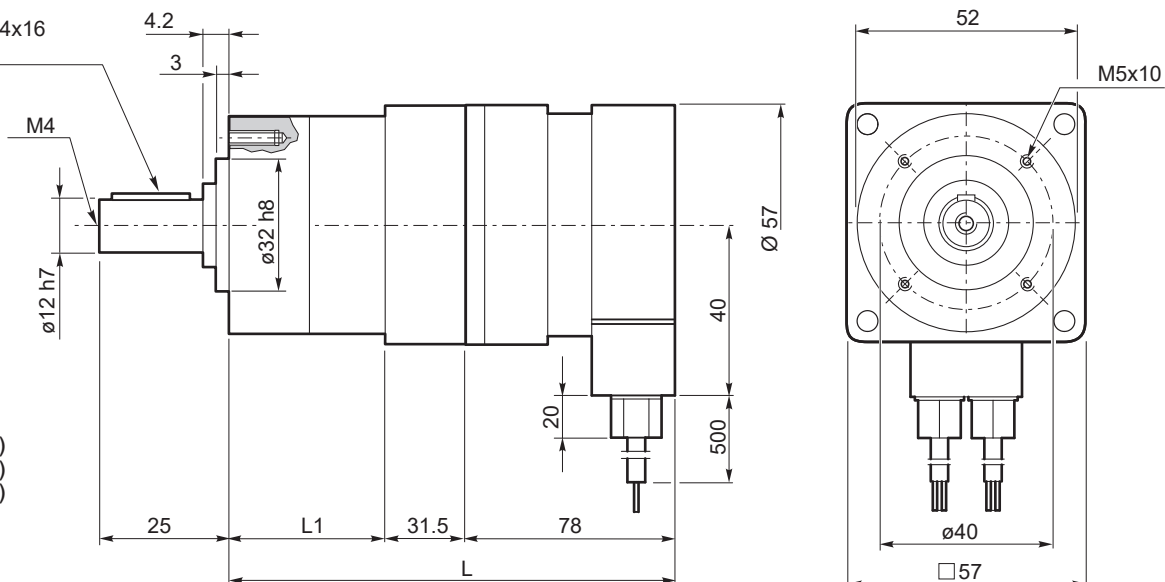

P52	BLS022.240		
	Ns	L1	L
	1	46	155.5
	2	60	169.5
	3	74	183.5

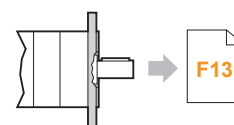

P52.. AS...

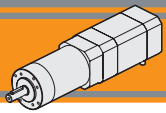

Motoriduttori brushless CC epicicloidali

Brushless DC planetary gearmotors

P52 con motore brushless CC

P52 with brushless DC motor

P52			BLS043.240																
			24V						36V										
Ns	ir	in	n _{2MIN} [rpm]			n _{2MAX} [rpm]			n _{1MAX} [rpm]	n _{2MIN} [rpm]			n _{2MAX} [rpm]			n _{1MAX} [rpm]			
			M ₂ [Nm]	sf		M ₂ [Nm]	sf			M ₂ [Nm]	sf		M ₂ [Nm]	sf					
1	3.7	4	81	1.3	4.6	811	1.3	3.1	3000	108	1.3	4.6	1081	1.3	2.8	4000			
	4.28	4	70	1.5	4.0	701	1.5	2.7		93	1.5	4.0	935	1.5	2.4				
	5.18	5	58	1.8	3.3	579	1.8	2.2		77	1.8	3.3	772	1.8	2.0				
	6.75	7	44	2.3	2.5	444	2.3	1.7		59	2.3	2.5	593	2.3	1.5				
2	13.73	14	22	4.4	3.9	218	4.4	2.6	3000	29	4.4	3.9	291	4.4	2.3	4000			
	15.88	16	19	5.1	3.4	189	5.1	2.3		25	5.1	3.4	252	5.1	2.0				
	18.36	18	16	5.9	2.9	163	5.9	2.0		22	5.9	2.9	218	5.9	1.7				
	19.2	19	16	6.2	2.8	156	6.2	1.9		21	6.2	2.8	208	6.2	1.7				
	22.2	22	14	7.2	2.4	135	7.2	1.6		18	7.2	2.4	180	7.2	1.4				
	25.01	25	12	8.1	2.1	120	8.1	1.5		16	8.1	2.1	160	8.1	1.3				
	26.9	27	11	8.7	2.0	112	8.7	1.4		15	8.7	2.0	149	8.7	1.2				
	28.9	29	10	9.3	1.8	104	9.3	1.3		14	9.3	1.8	138	9.3	1.1				
	35.0	35	8.6	11	1.5	86	11.3	1.0		11	11	1.5	114	11	0.9				
	45.6	46	6.6	15	1.2	66	14.7	0.8		8.8	15	1.2	88	15	0.7				
	3	50.9	51	5.9	15	2.4	59	15.3		1.6	3000	7.9	15	2.4	79		15	1.4	4000
		58.9	59	5.1	18	2.1	51	17.7		1.4		6.8	18	2.1	68		18	1.2	
68.1		68	4.4	20	1.8	44	20	1.2	5.9	20		1.8	59	20	1.1				
71.2		71	4.2	21	1.7	42	21	1.2	5.6	21		1.7	56	21	1.0				
78.7		79	3.8	24	1.6	38	24	1.1	5.1	24		1.6	51	24	0.9				
92.7		93	3.2	28	1.3	32	28	0.9	4.3	28		1.3	43	28	0.8				
95.2		95	3.2	29	1.3	32	29	0.9	4.2	29		1.3	42	29	0.8				
99.5		100	3.0	30	1.2	30	30	0.8	4.0	30		1.2	40	30	0.7				
107.2		107	2.8	32	1.1	28	32	0.8	3.7	32		1.1	37	31	0.7				
115.07		115	2.6	35	1.1	26	35	0.7	3.5	35		1.1	35	31	0.7				
123.97		124	2.4	37	1.0	24	36	0.7	3.2	37		1.0	32	31	0.7				
129.62		130	2.3	39	0.9	23	36	0.7	3.1	39		0.9	31	31	0.7				
139.13		139	2.2	42	0.9	22	36	0.7	2.9	42		0.9	29	31	0.7				
149.9		150	2.0	45	0.8	20	36	0.7	2.7	45		0.8	27	31	0.7				
168.84		169	1.8	51	0.7	18	36	0.7	2.4	51		0.7	24	31	0.7				
181.24		181	1.7	53	0.7	17	36	0.7	2.2	53		0.7	22	31	0.7				
195.26	195	1.5	53	0.7	15	36	0.7	2.0	53	0.7	20	31	0.7						
236.09	236	1.3	53	0.7	13	36	0.7	1.7	53	0.7	17	31	0.7						
307.54	308	1.0	53	0.7	9.8	36	0.7	1.3	53	0.7	13	31	0.7						

Rapporti preferenziali
Preferred ratios

Attenzione: superamento della coppia nominale supportata dal riduttore per servizio S1.
Contattare il ns. servizio tecnico
Attention: rated torque withstood by gear reducer for service in S1 is exceeded.
Please, contact our technical office.

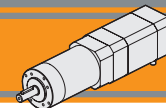

P52 con motore brushless CC

P52 with brushless DC motor

Tipo Type	Numero di poli Number of poles	Numero di fasi Number of phase	Tensione Rated voltage [V]	Numero di giri Rated speed [rpm]	Coppia nominale Rated torque [Nm]	Potenza nominale Rated power [W]
BLS043.240	4	3	36	4000	0.43	180
			24	3000		130
Tipo Type	Coppia massima Peak torque [Nm]	Corrente nominale Rated current [A]	Resistenza Resistance [ohm]	Induttanza Inductance [mH]	Corrente massima Peak current [A]	Peso Weight [kg]
BL043.240	0.86	6	0.35	1	12.0	1.25

Azionamenti
Drives



P52.. + BLS043.240

Linguetta 4x4x16
DIN 6885
Key 4x4x16
DIN 6885

Kg
2.8 (P52 1..)
3.1 (P52 2..)
3.3 (P52 3..)

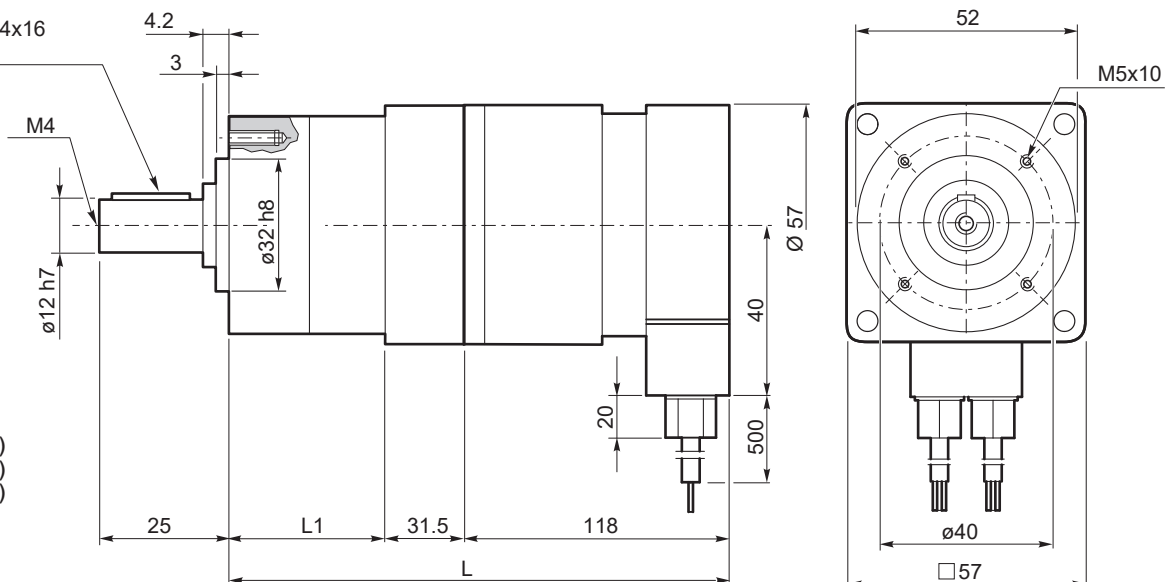

P52	BLS043.240		
	Ns	L1	L
	1	46	195.5
	2	60	209.5
	3	74	223.5

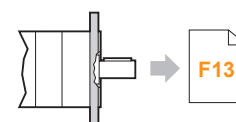

P52.. AS...